

Appleton Old Car Show and Swap Meet

40

1978

YEARS

2017



Pierce Park

SWAP MEET | CAR CORRAL  
TROPHIES IN 34 CLASSES

CONCESSIONS | 1000+ CARS  
FREE | PUBLIC INVITED

OPEN TO COLLECTOR CARS 1987 AND OLDER

Presented Cooperatively by:

JULY 16  
2017

Appleton Old Car Club, Inc.  
Appleton-Fox Cities Kiwanis  
Fox Valley Street Rod Association

Packerland Region Vintage  
Chevrolet Club of America  
Stephensville Street Rods

HOURS  
8-4

[www.appletonoldcarshow.com](http://www.appletonoldcarshow.com)

**1967 Toyota  
2000 GT**

**“Groovy”**



**“Sweet”**



**2018 Toyota  
Camry**

*The expressions may have changed in the last 50 years, but the beautiful styling, dependable engines and exhilarating performance continues to this day in the newly redesigned Toyota CAMRY. Test drive one today, and see what expression you'll come up with!*

*Proud to be  
a sponsor of the  
40th Annual Appleton  
Old Car Show &  
Swap Meet*

**KOLOSSO** **TOYOTA**

**“Serving the Fox Valley's Automotive Needs Since 1929”**

**3000 W. Wisconsin Ave., Appleton • 738-3666 • [KolossoToyota.com](http://KolossoToyota.com)**



[www.foxkiwanis.org](http://www.foxkiwanis.org)



[www.foxkiwanis.org](http://www.foxkiwanis.org)

## Appleton-Fox Cities Kiwanis

Celebrating over 30 years of providing delicious food and beverages to car enthusiasts attending the Appleton Old Car Show



over

# \$925,000

total dollars fundraised by our Kiwanis Club and reinvested into your community



We are Kiwanis. Kiwanis is a global organization of volunteers dedicated to changing the world one child and one community at a time. Chartered in 1972, we are a group of committed men and women who make a difference in our community through service and fellowship.

Join us every Friday at 7:15am at Atlas Coffee Mill.





# WELCOME TO THE APPLETON OLD CAR SHOW & SWAP MEET

**JOIN US FOR THE 23RD ANNUAL  
103.9 WVBO CLASSIC CAR SHOW CRUISE NIGHT!**

**SATURDAY, JULY 15TH  
AT FOX VALLEY TECHNICAL COLLEGE IN APPLETON**

**FREE to Spectators and Show Cars!**

**Show 3pm-6pm with a short cruise  
through downtown Appleton.**

**Trophies for Best in Show contemporary,  
Classic, Paint and WVBO DJ Favorites!**

**Plus trophy winners will be featured in the  
2018 WVBO Classic Car Calendar!**



## **SPECIAL THANKS & RECOGNITION**

is extended to the following **Appleton 2017 Car Show Supporters**  
who have helped make this year's show possible.

- |  |   |                                     |   |
|--|---|-------------------------------------|---|
| ■ 103.9 WVBO<br>The Valley's Best Oldies | ■ Booky's Hot Rod Shop                      | ■ Fox Valley Technical College      | ■ Packerland Region-Vintage Chevrolet Club of America |
| ■ A-1 Moving and Storage                 | ■ Bow Tie Cars, LLC                         | ■ Geiger Auto Body                  | ■ Peotter's Collision Center                          |
| ■ Accurate Alignment and Frame Service   | ■ Boy Scouts of America Troop 122/Menasha   | ■ J.D.'s Drive-In Restaurant        | ■ Reynebeau Upholstery                                |
| ■ AFS Services                           | ■ Brush Boy Customs                         | ■ J.H. Design                       | ■ Schmidt Auto Salvage                                |
| ■ Appleton Auto Recyclers                | ■ Car City                                  | ■ Jewel's Body Shop                 | ■ Sidelines Sports Bar                                |
| ■ Appleton Downtown, Inc.                | ■ Carew Golf Carts                          | ■ Joe's Collision and Restoration   | ■ St. Elizabeth's Hospital First Aid                  |
| ■ Appleton Harley Davidson               | ■ City of Appleton                          | ■ Keen's Auto Repair                | ■ Stephenville Street Rods                            |
| ■ Appleton Parks and Recreation Dept.    | ■ Classic Mechanics, LLC                    | ■ Knorr Auto Body                   | ■ The Chrome Shop                                     |
| ■ Appleton Police Department             | ■ Custom Plating Specialists, Inc.          | ■ Koehn Insurance Agency            | ■ Timeline Saloon & BBQ                               |
| ■ Appleton Trophy and Engraving          | ■ Erik Hosking - State Farm Insurance       | ■ Kolosso of Appleton               | ■ Toys For Trucks                                     |
| ■ Appleton-Fox Cities Kiwanis            | ■ FastSigns                                 | ■ Larry McGray's Antique Automotive | ■ Tri City Glass and Door                             |
| ■ Automotive Supply Inc.                 | ■ Ferrellgas of Appleton                    | ■ License To Cruise 2017            | ■ Van's John D Towing                                 |
| ■ Automotive Specialties                 | ■ Festival Foods                            | ■ Madison Classics                  | ■ Waste Management                                    |
| ■ Baumgart Tire and Wheel Inc.           | ■ Fox Cities Convention and Visitors Bureau | ■ Metal Products, Inc.              | ■ WE Energies   |
|  | ■ Fox Cities Magazine                       | ■ Mike Murphy Ford, Inc.            | ■ Wisconsin Distributors Appleton                     |
|  | ■ Fox Valley Early Birds                    | ■ Miller Electric                   |   |
|  | ■ Fox Valley Street Rod Association         | ■ Neuman Auto Frame                 |   |
|  |   | ■ Northeast WI Corvair Club         |   |



**Complete Restoration Service**  
**Collector Car Sales • Indoor Showroom**  
**Larry & Janice McGray**  
 Phone 920-834-4447 • [www.antique-automotive.com](http://www.antique-automotive.com)  
 Stiles Junction • Hwys 141 and 22  
 5913 Military Road • Lena, WI 54139

*For Show Information Write:*

### **APPLETON OLD CAR SHOW**

P.O. BOX 863 • APPLETON, WI 54912

*Or Call:* **GENERAL INFO** **SWAP MEET**  
 920-731-8519 920-733-3945

*Or Visit Us On the Web at:*  
[www.appletonoldcarshow.com](http://www.appletonoldcarshow.com)

## **APPLETON 2017 WEEKEND EVENTS**

### **JULY 15 - SATURDAY**

23rd Annual 103.9/WVBO

Classic Car Show & Cruise - FREE Event!

3:00 - 6:00 p.m.

Fox Valley Technical College • Appleton, WI

COME JOIN IN THE FUN!

### **JULY 16 - SUNDAY**

40th ANNUAL OLD CAR SHOW & SWAP MEET

- PIERCE PARK

6:00 a.m. Vendor Set-up

8:00 a.m. Show Car Registration Opens  
 Pavilion Stage

11:00 a.m. Face Painting/Pavilion until 3pm

1:00 p.m. Show Car Voting Closes

2:00 p.m. Vehicle Entry Closes

3:30 p.m. Show Car Award Presentations

3:45 p.m. Miller Electric Co. Welder Drawing  
 (MUST BE PRESENT TO WIN)

Open to cars 1987 and older

# **2017 Appleton Old Car Show & Swap Meet SAYS THANKS to Our Dedicated Volunteers!**

**To View Map**  
 scan this code  
 with your smart phone!



2017 is the 40th Anniversary of the Appleton Old Car Show and Swap Meet. This year's show is grateful to all the dedicated volunteers that help make this show successful as all of the wonderful classics roll through the park's gates. If you own one of these fine cars, please make plans to attend this year's show to display your car with fellow

car owners and enthusiasts. If you have a nice photo of your car, please send it to us. We would like to add it to our web site: [www.appletonoldcarshow.com](http://www.appletonoldcarshow.com). Your participation will be appreciated by the tens of thousands of old car enthusiasts who annually attend the show. This year's show is grateful to the following clubs and all the volunteers that make this show possible: • **Joe Theisen and friends** at the front gate • **Fox Valley Street Rod Members** for classing and registering cars • **The Packerland Region Vintage Chevrolet Club of America** for taking care of all the vendor and car corral set up and registration • **The Stephenville Street Rods** for handling all the parking duties • **Appleton Fox Cities Kiwanis** for handling all the food and refreshment activities • **Appleton Old Car Inc.** for managing and organization of the show. Hope you are able to attend this family-friendly event! ♦

**Please: No carry-in alcoholic beverages are permitted.**

The park is licensed for the sale of beer as part of the food and beverage concessions. Concession proceeds beyond the cost of producing the largest free car show in the area are all directed back into the community to help make the Fox Valley a better place to live and work. *Thank you.*

## **Table of Contents**

List of Car Show Supporters .....	4
WVBO Car Show & Cruise Night .....	4
Schedule of Events .....	5
General Information .....	7
Swap Meet Registration Form .....	11
Car Corral Registration Form .....	11
Show Car Trophy Sponsors .....	12
Trophy Classification .....	13
Miller Electric Welder Give-Away .....	13





*Quality Machining Since 1969*

**OEM Machining Contractor for the following Industries:**

Construction Equipment, Specialty Trucks, Paper Machines, Food Packaging, Printing Presses, Weld Equipment, Plastic Converting, Machine Tools, Warehousing, Quality Control and Engineering.

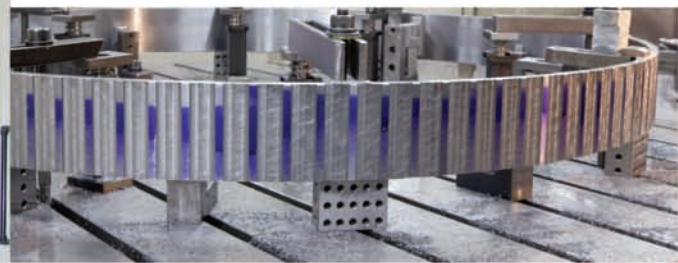

**Tool & Die Turn-Key Manufacturing:**

Trim Dies, Weld Fixtures, Machining Fixtures, Extrusion Dies, and Gauges.



**Maintenance Services:**

Rebuild Vane, Impeller and Screw-Type Compressors, Roll Repair, Machine Rebuilding, Dynamic Balancing, Reverse Engineering, Laser Coupling Alignment, and Pump Rebuilding.

**Large Capacity Machining and Inspection services.**

*Metal Products, Inc., embraces the ISO 9001:2015 standards for Quality Management:  
To be the standard of quality to our Customers and to support continuous process improvement.*

[www.metprod.com](http://www.metprod.com)

1201 North Perkins Street  
Appleton, WI 54914

Phone: 920-739-6511 Fax: 920-739-7794



## General Information

### Appleton Old Car Show & Swap Meet GENERAL CAR SHOW INFORMATION

**QUALIFY:** The show is open to Collector Cars and Trucks that are 1987 and older.

**ADMISSION:** The car show and all activities on the grounds are **FREE** to Old Car enthusiasts and spectators, including youth activities.

**OLD CAR REGISTRATION:** There are no registration fees and each old car registered will receive the following:

- 40th Annual Meet Dash Plaque - First 1000 entrants
- Trophies - Opportunity to win one of over 35 trophies based on car show entrants voting within their class.
- Registration for **FREE** Miller Welder by raffle for car show owner participants - Winner must be present at time of drawing to win.

Registration for show cars and their participants is held at the stage of the pavilion on the east side. This is an excellent location to secure directions or emergency assistance.

**CAR SHOW HOURS:** Cars may enter the show field no earlier than 8:00 a.m. and will not be allowed into show after 2:00 p.m. The official and basically only acceptable entrance to the car show is located on the southwest corner of the intersection of Prospect and Pierce Streets. Please look for signs and follow the directions of show staff.

**GROUND RULES:** Due to the heavy concentration and close proximity of the show cars in the park, strict fire regulation will be enforced. NO OPEN FIRES, grills, or cooking fires will be permitted in the park the day of the car show. The show sponsors wish to encourage a minimum amount of car movement in the show area and that movement should be made at a safe and respectable pace as not to hazard participants or spectators. Flame throwing, burnouts and spinning of tires in park are strictly forbidden.

**FOOD ON GROUNDS:** A very tasty, well-prepared and reasonably-priced array of food is prepared on the grounds by the Appleton Fox Cities Kiwanis as their major fundraiser for 2017. The food stand is located on the west side of the pavilion, and there are additional food and beverage stands located throughout the park.

**SWAP MEET & CAR CORRAL:** A very popular and well-attended area has been designed within the park for a Swap Area and Car Corral. Reservations for Swap spaces and Car Corral are available on another page in this book. The Car Corral is a designated area where cars for sale are parked in a reserved paid-for space. Please note that NO FOR SALE SIGNS are allowed on cars parked in the car show display areas. Cars with For Sale signs will be asked to remove them and/or remove their car from the show. The Swap and Car Corral are located on the northwest side of the park. Use park map for directions. The entrance to the Swap Meet and Car Corral for vendors is the entrance to Piece Park from Prospect on the North side of the park. Swap vendors will use the right lane and circle down through the lower parking lot then stop, check registration and be guided to their stalls. Vehicles entering the Car Corral will use the same north entrance off Prospect, but use the left lane through the entrance, stop for registration, then proceed by direction to the Car Corral.

**FIRST AID & EMERGENCIES:** A first aid station has been established on the south end of the pavilion for any emergency. Police are available on the grounds during the car show. For best information or for an emergency, head for the registration stand in the pavilion.

**HANDICAPPED PARKING:** A handicap parking area has been designated just inside and on the west side of the Prospect Street entrance to Pierce Park.

**RESTROOM & TOILET FACILITIES:** A restroom is located just off of the pavilion on its Northwest corner. There are also port-a-potties located throughout the grounds.

**INVITED CLASSICS:** The Appleton Old Car Show has invited a select group of Classics and Old Cars to participate in The GREAT MOTORING MEMORIES display. This tented and roped-off area, east of the pavilion, presents some of the area's classic automobiles and outstanding examples of unique and one-of-a-kind vehicles that have achieved prominence in automobile history. Preference is given to brass-era antique and classic cars. In past years, many of the cars featured have received the prestigious honor of having been judged national winners in concours competition. The public is invited to view these selected old cars. When enjoying any of the hundreds of cars on display please respect the value of these cars to their owners.

**TRADEMARK:** The Appleton 2017 symbol is a trademark of the Appleton Old Car Club. Reproduction in any form, on any item, is restricted to authorized vendors. All such requests must be received and authorized prior to July 1, 2017. **FOR MORE INFORMATION PHONE 920-731-8519**

[www.appletonoldcarshow.com](http://www.appletonoldcarshow.com)  
by scanning this code  
with your smart phone!



## All roads lead to JD's Drive-In!

"Your Neighborhood  
Drive-In"  
Since 1968



Between Mead Pool & Appleton East High School

920-739-6935

1939 E. John Street, Appleton, WI 54915

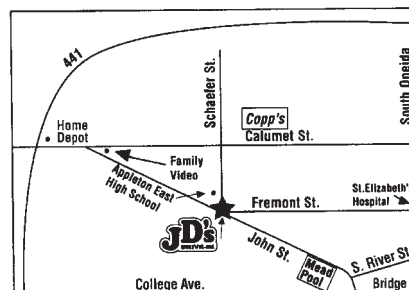

[www.appletonoldcarshow.com](http://www.appletonoldcarshow.com)



## WISCONSIN'S PREMIER SHOWS!

### SUMMER **ELKHORN** 32<sup>ND</sup> ANNUAL! AUGUST 5- 6, 2017

WALWORTH CO. FAIRGROUNDS, ELKHORN, WI



**CAR SHOW, SWAP MEET &  
CARS FOR SALE BOTH DAYS!**  
1,100+ Swap Spaces  
100's of Cars for Sale  
**All Makes/Models Welcome**  
Featuring Trucks!

### FALL **JEFFERSON** 40<sup>TH</sup> ANNUAL! SEPTEMBER 22 - 24, 2017

JEFFERSON CO. FAIRGROUNDS, JEFFERSON, WI



**2 DAY CAR SHOW (SAT. & SUN.)  
3 DAY SWAP MEET/CARS FOR SALE**  
3,100+ Swap Spaces  
100's of Cars for Sale  
**All Makes/Models Welcome**  
Featuring Camaros & Chevelles!



**Info: (608) 244-8416**  
**madisonclassics.com**



Hosking Insurance Agency Inc  
Erik Hosking, Agent  
2221 Freedom Road Suite D  
Little Chute, WI 54140  
Bus: 920-788-5000

## Car + Home Savings

Total average savings of

**\$827\***

Let me show you how  
combining home and auto  
policies can really add up.

Like a good neighbor,  
State Farm is there.®

**CALL ME TODAY.**



\*Average annual per household savings based on a 2016 national survey of new policyholders who reported savings by switching to State Farm. Each insurer has sole financial responsibility for its own products.

State Farm Mutual Automobile Insurance Company (auto), Bloomington, IL,  
State Farm Lloyds (home), Dallas, TX  
0907501TX.1

# ENJOY

# CREATE

# DISCOVER

## SUMMER EVENTS 2017

### ART ON THE TOWN

Third Friday of the Month  
May - September • 5:00-8:00 p.m.

### CREATIVE KIDS

Houdini Plaza  
July 21 & Aug. 18 • 3:00-5:00 p.m.

### LUNCHTIME LIVE CONCERTS

Houdini Plaza  
Thursdays, June 1 - Aug. 31  
11:30 a.m. - 1:00 p.m.

### HEID MUSIC SUMMER CONCERT SERIES

Thursdays, June 1 - Aug. 31  
5:30 - 8:30 p.m.

### NOON TUNES

Creative Parklet  
Wednesdays, June 7 - August 30  
12:00 - 1:00 p.m.

### DOWNTOWN APPLETON FARM MARKET

Saturdays, June 17 - October 28  
8:00 a.m. - 12:30 p.m.



#onegreatplace



**appletondowntown.org**





Friday, September 29, 2017  
College Avenue, Appleton  
6:00 – 9:30 pm



Enjoy the Doo-Wop Daddies in Houdini Plaza, 6:00 – 9:30 PM  
Street corner performers throughout College Avenue

EVENT SPONSORS



Check out our new interactive website for  
event day updates: [octoberfestonline.org](http://octoberfestonline.org)



Download the  
Octoberfest app at







## Joe Theisen

N 966 Quality Dr.  
Greenville, WI 54942  
Fax: (920) 757-6702  
Email:  
joe@joescollisionandrestoration.com

Foreign & Domestic Collision Repair  
Classic Automobile Restoration • Fiber Glass Repair  
Truck & SUV Accessories • U-Haul Rentals

*"The Valley's Quality Repair Shop Since 1979"*



## KOEHN INSURANCE AGENCY, INC.

Business & Personal Insurance

1000 W. Wisconsin Ave #2  
Appleton, WI 54914  
Phone 920-739-7111  
Fax 920-739-6216  
Toll Free 877-233-7111  
mike@koehninsurance.com

MIKE KOEHN  
PRESIDENT

**Tri City**  
Glass & Door  
AUTOMOTIVE • RESIDENTIAL • COMMERCIAL

Your glass experts for any  
"CLASSIC" car or truck!

920.731.8176  
800.521.5221  
100 W. Northland Ave.  
Appleton, WI 54911

www.tricityglass-door.com

920.468.7820  
800.242.8177  
1811 E. Mason St.  
Green Bay, WI 54302

An Employee Owned Company

## Knorr Auto Body



1292 Manitowoc Road  
Menasha, WI 54952

**Erik Reiter**  
Owner

Phone 920.725.2636  
Cell 920.257.7834

## TIMELINE SALOON & BBQ

Located 18 miles West of Green Bay on Highway 29,  
next door to Doc's Harley-Davidson



*Home of the "World Famous" Timeline Motorcycle*

Specializing in Slow-Roasted BBQ Ribs, Pulled Pork,  
Beef Brisket, Real Charcoal Grilled Steaks & Burgers.  
715-758-RIBS (7427) Reservations & Carry-out  
Serving Breakfast, Lunch & Dinner 7 Days a Week

*Classic Car & Antique Motorcycle*

**Cruise Night** Tuesdays  
5pm-close



Cruise in with your classic car  
or antique motorcycle & get  
20% OFF your meal!

WWW.TIMELINESALOON.COM

## CHROME

CUSTOM  
PLATING  
SPECIALIST  
INC.

Brillion, WI

920-756-3284

*We Do It All!*

Repairs • Cars • Motorcycles  
Vintage Boats • Pot Metal • Antiques  
Polish Stainless Molding • Repairs

Come see us at our booth for a **FREE Estimate!**



Email for Quote:  
tmeetz@aol.com



Visit Our Website:

www.CustomPlatingSpecialist.com

www.appletonoldcarshow.com





# Swap Meet & Car Corral Forms

## Swap Meet Registration Form (Please print)

Name/Company \_\_\_\_\_

Contact Person \_\_\_\_\_

Address \_\_\_\_\_

City \_\_\_\_\_ State \_\_\_\_\_ Zip \_\_\_\_\_

Email Address \_\_\_\_\_

### No. of Spaces (spaces may contain trees)

\_\_\_\_\_ 15 x 20 Outdoor Space, \$35.00 through July 1st Total \$ \_\_\_\_\_

\_\_\_\_\_ 15 x 20 Outdoor Space, \$40.00 after July 1st Total \$ \_\_\_\_\_

Swap spaces frontage can vary between 15 and 20 ft. of frontage depending on layout. All items **MUST** be within your allotted space. We do not provide space for your vehicle or trailers on grounds. Large trucks and trailers please come early (Saturday afternoon) if possible in order to maneuver into your space. PLEASE take ALL parts back home — DO NOT leave in park!

Total amount enclosed \$ \_\_\_\_\_

Description of products to be sold \_\_\_\_\_

Make checks payable to "Appleton Old Car Show" and Mail to:

**Appleton Old Car Show Swap Registration**

2701 North Ullman St., Appleton, WI 54911

**Advance Registration will be confirmed time permitting.**

## Car Corral Registration Form (Please print)

Name/Company \_\_\_\_\_

Contact Person \_\_\_\_\_

Address \_\_\_\_\_

City \_\_\_\_\_ State \_\_\_\_\_ Zip \_\_\_\_\_

Email Address \_\_\_\_\_

### No. of Spaces

\_\_\_\_\_ Car Corral Space, \$35.00 through July 1st Total \$ \_\_\_\_\_

\_\_\_\_\_ Car Corral Space, \$40.00 after July 1st Total \$ \_\_\_\_\_

Total amount enclosed \$ \_\_\_\_\_

• **NOTICE - CARS IN CAR CORRAL MUST BE 1991 OR OLDER**

• **NO FOR SALE SIGNS WILL BE PERMITTED ON SHOW CARS.**

Make checks payable to "Appleton Old Car Show" and Mail to:

**Appleton Old Car Show Car Corral Registration**

2701 North Ullman St., Appleton, WI 54911

**Advance Registration will be confirmed time permitting.**



**Restorations  
Custom Builds  
Repairs  
All Makes**

[www.BowTieCars.com](http://www.BowTieCars.com)



**851 Cty Rd G  
Neenah WI  
(920) 279-5521**

**THE CHROME SHOP**  
Specializing in Custom Plating

**Steve Campbell**

565 Olde Midway Rd.  
Menasha, WI 54952

(920) 727-9444 Shop  
(920) 727-9466 Fax  
dacmarx@yahoo.com

Mon-Thurs: 7-3:30 • Fri: 7-3



[www.appletonoldcarshow.com](http://www.appletonoldcarshow.com)

# TROPHY SPONSORS

## Please patronize these generous sponsors!

### ACCURATE ALIGNMENT & FRAME SERVICE

3020 W. Franklin  
Appleton, WI 54914  
920-731-5442

### AFS SERVICES

330 E. Main  
Hortonville, WI 54944  
920-779-4199

### APPLETON AUTO RECYCLERS

W4982 Cty. Rd. O  
Appleton, WI 54913  
920-733-0979

### APPLETON HARLEY DAVIDSON

5322 Clairemont Drive  
Appleton, WI 54913-8837  
920-757-1651

### APPLETON TROPHY & ENGRAVING, INC.

2401 N. Richmond St.  
Appleton, WI 54914  
920-739-3569

### AUTOMOTIVE SUPPLY CO.

116 W. Third Street  
Kaukauna, WI 54130  
920-766-4686

123 S. Linwood Ave.  
Appleton, WI 54914  
920-734-2651

### AUTOMOTIVE SPECIALTIES

7313 State Rd. 76  
Neenah, WI 54956  
(920) 727-0116

### BAUMGART'S TIRE & WHEEL, INC.

914 W. Wisconsin Ave.  
Appleton, WI 54914  
920-739-3971

### BOOKY'S HOT ROD SHOP

Hortonville, WI 54944

### CAR CITY

1930 W. College Ave.  
Appleton, WI 54914  
920-734-0942

### CHROME SHOP, THE

565 Olde Midway Road  
Menasha, WI 54952  
920-727-9444

### CLASSIC MECHANICS, LLC

1005 W. American Drive  
Suite B  
Neenah, WI 54956  
920-486-1771

### DOC'S BOW TIE CARS

851 Cty Rd G  
Neenah, WI 54956  
(920) 279-5521

### FOX VALLEY EARLY BIRDS

1122 Sunny Hill Court  
Green Bay, WI 54313  
(414) 756-2549

### FOX VALLEY STREET ROD ASSOCIATION

W8695 Spring Road  
Hortonville, WI 54944

### GEIGER AUTO BODY

7285 S. State Road 76  
Neenah, WI 54956  
920-725-3267

### J.D.'s DRIVE-IN RESTAURANT, INC.

1939 E. John St.  
Appleton, WI 54915  
920-739-6935

### JOE'S COLLISION AND RESTORATION

N966 Quality Drive  
Greenville, WI 54942  
920-757-6763

### KEEN'S AUTO REPAIR

1845 W. Wisconsin Ave.  
Appleton, WI 54914  
920-733-0124

### KNORR AUTO BODY

1292 Manitowoc Road  
Menasha, WI 54952  
920-725-2636

### NEUMAN AUTO FRAME

406 E. Main Street  
Hortonville, WI 54944  
920-779-5938

### NORTHEAST WI CORVAIR CLUB

1274 E. Shady Lane  
Neenah, WI 54956  
(920) 722-1225

### PACKERLAND REGION - VINTAGE CHEVROLET CLUB OF AMERICA

3401 Lau Lane  
Brillion, WI 54110  
920-756-3849

### PEOTTER'S COLLISION CENTER

5555 W. Wisconsin Ave.  
Appleton, WI 54914  
920-733-3893

### REYNEBEAU UPHOLSTERY

333 W. Wisconsin Ave.  
Appleton, WI 54911  
920-734-1086

### SIDELINES SPORTS BAR

W6278 Greenville Drive  
Greenville, WI 54942  
(920) 757-9810

### SCHMIDT AUTO SALVAGE

415 E. Main Street  
Hortonville, WI 54944  
(920) 779-0733

### TOYS FOR TRUCKS

W6411 Greenville Drive  
Greenville, WI 54942  
920-757-0680

### VAN'S JOHN D TOWING

W6383 Everglade Road  
Greenville, WI 54942  
920-470-3547

## 2018 SHOW DATE ~ JULY 15th

# JEWEL'S BODY SHOP

## 47 YEARS

LET US RESTORE YOUR CLASSIC OR ANTIQUE AUTOMOBILE

### T-Bird Experts Restorations Buying and Selling



Mechanical ■ Electric ■ Body ■ Paint ■ Convertible Tops ■ Rotator Restoration  
920-989-1505 920-756-2549 CELL: 920-450-5555 W2817 DUNDAS RD., BRILLION, WI 54110



[www.appletonoldcarshow.com](http://www.appletonoldcarshow.com)



## Reynebeau Upholstery

333 W. Wisconsin Ave. Appleton, WI 54911

reynebeau.com

920-734-1086



**APPLETON**  
Old Car Show and Swap Meet

## 2017 TROPHY CLASSIFICATIONS

GENERAL	A	1900 - 1931	GENERAL
	B	1932 - 1948	GENERAL
	C	1949 - 1954	GENERAL
	D	1955 - 1957	GENERAL
	E	1958 - 1961	GENERAL
	F	1962 - 1964	GENERAL
	G	1965 - 1967	GENERAL
	H	1968 - 1970	GENERAL
	I	1971 - 1973	GENERAL
	J	1974 - 1976	GENERAL
	K	1977 - 1980	GENERAL
	L	1981 - 1984	GENERAL
	M	1985 - 1987	GENERAL
GM	N	1955 - 1957	CHEVROLET
	O	1953 - 1987	CORVETTE
	P	1967 - 1987	CAMARO/FIREBIRD
	Q	1964 - 1987	CHEVELLE/MALIBU
	R	1964 - 1974	GTO
	S	1960 - 1969	CORVAIR
	T	1955 - 1957	THUNDERBIRD
FORD	U	1958 - 1987	THUNDERBIRD
	V	1964 - 1987	MUSTANG
MOPAR	W	1966 - 1978	CHARGER
	X	1962 - 1987	PLYMOUTH
	Y	1962 - 1987	DODGE
OTHER	Z	1900 - 1957	TRUCKS
	AA	1958 - 1972	TRUCKS
	BB	1973 - 1987	TRUCKS
	CC	1900 - 1934	STREET RODS
	DD	1935 - 1948	STREET RODS
	EE	1935 - 1987	CUSTOMS
	FF	1949 - 1987	STREET MACHINES
	GG	1900 - 1987	SPORTS CAR
	HH	1900 - 1987	AMC, NASH, HUDSON
	MAYOR'S CHOICE		
BEST OF SHOW - PRE WAR			
BEST OF SHOW - POST WAR			
CONCOURS D' ELEGANCE			
All Show Cars Must Be 1987 and Older. NO EXCEPTIONS.			

## Register to WIN

the **Miller Electric Welder** at the Pavilion!

As in previous years, the great community-minded Miller Electric Company of Appleton, Wisconsin, has made a wonderful donation available to the Appleton Old Car Show. Any person registering a 1987 car or older at the Appleton Old Car Show will have an opportunity to win a Miller Electric Millermatic wire-feed welder ideally suited for working on any old car restoration project and a perfect piece of equipment for the restorer that has set high standards on the quality of his/her work. It is also the perfect welder for many other jobs at home and on the job. The random drawing will be held during the trophy presentation normally mid-afternoon on Sunday. Please note that all the registered participants at the show are eligible and **participants MUST BE PRESENT TO WIN** the welder. Stop by the pavilion, fill out the entry form, and place it in the bucket for your chance to win! ♦



2016 Miller Welder Winner: Eugene Schapp • Plymouth, WI

*Mike Murphy*  
*Ford, Inc.*



Serving The Hortonville Area  
For Over 30 Years

New and Used Vehicle Sales  
And Service

109 N. Mill St., Hortonville, WI 54944

Phone: (920) 779-4076

[www.appletonoldcarshow.com](http://www.appletonoldcarshow.com)

**Serving the Valley for 89 Years!**



123 S. Linwood Ave.  
Appleton, WI 54914  
920-734-2651



- ◆ Domestic & Foreign Parts ◆
- ◆ Machine Shop Service ◆
- ◆ Tools and Equipment ◆
- ◆ Paint & Body Supplies ◆

*We Custom Mix Spray Cans  
For Any Car, Any Color!*



[www.automotivesupplyco.com](http://www.automotivesupplyco.com)

APPLETON ◆ FOND DU LAC ◆ BRILLION ◆ GREEN BAY ◆ KAUKAUNA ◆ MENOMINEE, WI ◆ NEW LONDON ◆ OSHKOSH ◆ SHAWANO ◆ WAUPACA



# **FAST SIGNS®**

More than fast. More than signs.®

Appleton | Green Bay

[www.fastsigns.com/267](http://www.fastsigns.com/267)

[www.appletonoldcarshow.com](http://www.appletonoldcarshow.com)



FPO  
WAITING FOR AD



THIS  
BUD'S  
FOR  
YOU.





TM



## Dreams

They're more than rides. They're inspirations to fuel the soul. Speed, glory and muscle. Every custom detail designed and built by Mike and Jim Ring and the crew at Ringbrothers.

**Together, we build dreams.**

**See what  
people like you  
build with Miller.**

[MillerWelds.com/webuild](http://MillerWelds.com/webuild)



**Miller.**

The Power of Blue®

